

RIBA 



# Architectural and Construction MBA

Supporting architectural excellence  
with business acumen





# THE RIBA MBA

---

A COLLABORATIVE ALLIANCE BETWEEN A LEADING GLOBAL BUSINESS SCHOOL AND THE ROYAL INSTITUTE OF BRITISH ARCHITECTS (RIBA NW) WHO HAVE PROVIDED QUALITY, RELIABILITY AND DISTINCTION IN THE FIELD OF ARCHITECTURE AND CONSTRUCTION FOR OVER 175 YEARS.

- 04 Messages from the Dean and the Chairman
- 06 Why choose the Architectural and Construction MBA?
- 08 Accreditation of prior learning
- 10 Programme modules
- 14 The RIBA Management project
- 16 The structure: What happens when
- 18 How you study
- 19 A student perspective
- 20 Our entry requirements
- 22 How to apply

The RIBA (NW) architectural and construction management MBA will enable you to combine and then apply the expertise provided by the Bradford Management School and the Royal Institute of British Architects. The bedrock of the provision is formed by a collaborative alliance between the longest established university business school offering the MBA award which is currently ranked within the top 10 business schools in the UK by the Financial Times (FT) and a Business superbrand, having offered quality, reliability and distinction in the field of architecture and construction for over 175 years.

---



I am fully convinced that there is significant value in the uptake of management and legal education based around practical and relevant real life situations.

The study of management and business often offers up a wider perspective on how expertise and capital can be leveraged to best effect.

I am especially pleased to see a partnership established between the RIBA and Bradford University Management School.

**DR SARAH DIXON**  
**DEAN OF THE MANAGEMENT SCHOOL**



The construction industry faces difficult times and an uncertain future.

One of the issues that has arisen is that architects have automatically focused on what they do best: Design. This leads in certain instances to a shift in focus away from the fee earning business side of architecture. management, legal and administrative processes that enable architects to produce excellence in design and execution must be incorporated into an architect's skill set.

**GEOFF ALSOP**  
**CHAIRMAN OF RIBA NORTH WEST**

The MBA in architectural and construction management will feature specific modules in The legal environment of business, law and sustainability in the built environment and project and practice management in architectural construction. These are areas that RIBA have identified as preferable in a dynamic and diverse field that juxtaposes building utility and creative flair within a business context. These RIBA prescribed modules will sit alongside the modules that make up the AMBA and EQUIS accredited Bradford MBA. When combined these elements will provide architects and those in construction with a solid foundation in business administration from which the economic and creative potential of design and construction projects can be realised.

# WHY SHOULD YOU CHOOSE THE RIBA ARCHITECTURAL AND CONSTRUCTION MBA?

---

## **World-class ranking and global accreditation**

By forging a partnership with the Royal Institute of British Architects NW (RIBA) the Bradford University School of Management is expressing a firm commitment to continue delivering internationally excellent learning, teaching and research in close collaboration with business. The resulting MBA award will be highly regarded everywhere you work. The Financial Times (FT) placed us 9th in the UK and 33th amongst European business schools in its December 2010 ranking of top business schools.

This shared delivery and accreditation of prior architectural and construction learning and experience make the provision unique. The MBA is the only MBA with professional recognition from a RIBA governing body.

## **Research excellence**

High-quality research underpins any world-class business school.

The Higher Education Funding Council rates our research as internationally excellent in some areas and nationally excellent in others. The research expertise is expressed in both the RIBA and the Bradford Management School and this international research standing will be used during the dually supervised architecturally based management projects.





### **Exceptional students**

Our students are our greatest asset. They are ambitious, committed and ready for hard work. Most see their Bradford MBA both as a means of fast-tracking their career and as an inspiring intellectual challenge. Our students have at least three years' relevant postgraduate work behind them, and bring invaluable diverse experience and insight from all over the world to the programme. Students here appreciate the combination of a flexible approach with the rigour of world-class courses and teaching staff.

The RIBA MBA is an opportunity for students to change their life, refresh their career or pursue a new direction, and to gain an advanced qualification that will bring them personal satisfaction and provide the foundation for future professional development.

# ACCREDITATION OF PRIOR LEARNING



THE RIBA HOLDS THE CONCEPT OF CONTINUING PROFESSIONAL DEVELOPMENT (CPD) IN HIGH REGARD AND TO THIS END THE RIBA PART III QUALIFICATION AND CPD PORTFOLIO OF THE POTENTIAL CANDIDATE WILL BE ACCREDITED TOWARDS THIS MBA AWARD UP TO A VALUE OF 30 CREDITS.



STUDENTS ON THIS COURSE CAN ATTAIN A POST GRADUATE CERTIFICATE IF THEY SUCCESSFULLY ACHIEVE 60 CREDITS. ON COMPLETION OF A FURTHER 60 CREDITS, STUDENTS WILL BE ELIGIBLE FOR THE AWARD OF POSTGRADUATE DIPLOMA IN BUSINESS AND MANAGEMENT. ON COMPLETION OF 180 CREDITS, STUDENTS WILL BE ELIGIBLE FOR THE AWARD OF MASTER OF BUSINESS ADMINISTRATION (MBA).



# PROGRAMME MODULES

---

THE CORE MODULES GIVE YOU A THOROUGH GROUNDING IN THE DISCIPLINES OF MANAGEMENT AND PROVIDE A FRAMEWORK FOR THE REST OF THE RIBA MBA. THEY DELIVER THE SPECIALIST KNOWLEDGE, SKILLS AND TECHNIQUES YOU CAN USE TO IMPROVE BUSINESS PERFORMANCE. AS PART OF OUR COMMITMENT TO SUSTAINABLE DEVELOPMENT, WE EMBED INDIVIDUAL AND COLLECTIVE SOCIAL AND CORPORATE RESPONSIBILITY IN ALL TEACHING AND LEARNING.



### **Law and sustainability in the built environment**

Focuses upon law in context with the detailed critical analysis of the responsibilities and accompanying liabilities that arise when architectural works are designed and executed. This module is at the forefront of the academic and practical boundaries of the area.

### **Legal environment of business**

This module will enable students to critically analyse how the structure and function of the legal system affects business strategy and decision making. It will also enable a student to explore and apply legal rules, doctrines and concepts within business situations to develop and execute strategies appropriately.

## **Project and practice management in architecture and construction**

This module will deliver expertise in architectural and construction project and practice management by providing overview and critical insight into the initial design and subsequent management of construction projects. Relevant concepts and strategic issues will be analysed so that a candidate on this module is provided with the skills that add value and provide a service to clients.

## **Business accounting**

You'll gain an in-depth understanding of the fundamental concepts and techniques in business accounting, as well as the accountant's role in the organization.

## **Business economics**

Get to grips with the workings of an organization's market environment, the economics of company growth strategies, and learn the skills needed to apply economic concepts to business problems.

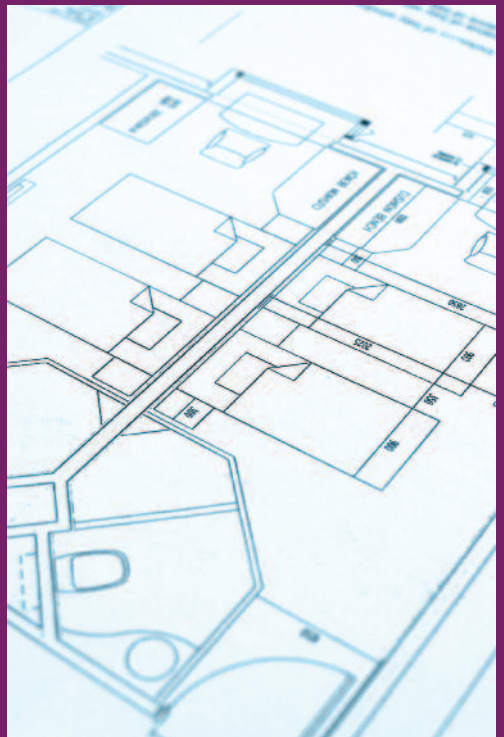

---

### **Business research**

You will develop a critical awareness of the quality of business research, improve your ability to design, carry out and present research.

### **Corporate finance**

You will discover how to make and implement financial decisions and how to criticise corporate financial policy through a detailed understanding of how capital markets operate.

### **Marketing**

You will gain critical awareness of the concepts and principles of marketing and their applications, as well as developing refined analytical, problem-solving and creative skills.

### **Managing people**

You'll learn about the issues that affect human behaviour in organizations, investigate the relationship between organizational behaviour, theory, development and human resource management, and find out how to work more effectively in the organization.

### **Operations management**

You'll develop a sound understanding of operations management in all types of organizations and achieve experience of some of the concepts and techniques that support decision-making in this field.

### **Strategic management**

You'll analyse the significance of business environments, competitive resources and advantage, and methods available for choosing appropriate corporate and business strategies and control.





OUR STUDENTS OFTEN FIND THE MANAGEMENT PROJECT TO BE THE MOST REWARDING AND CHALLENGING PART OF OUR PROGRAMME. IT ENABLES YOU TO PUT THE KNOWLEDGE AND SKILLS YOU HAVE GAINED THROUGHOUT THE PROGRAMME TO PRACTICAL USE ON A RELEVANT MANAGEMENT ISSUE. THE PROJECT INVOLVES CONDUCTING AN ORIGINAL AND DETAILED INVESTIGATION OF A SPECIFIC BUSINESS MANAGEMENT PROBLEM, WRITTEN IN A 15,000-WORD DISSERTATION. WE PROVIDE PLENTY OF SUPPORT AND GUIDANCE TO HELP YOU TO MAKE THE RIGHT CHOICE OF TOPIC AND, OF COURSE, DURING THE PROJECT ITSELF.



# THE RIBA MANAGEMENT PROJECT

---



“The management project is where the skills that have been learnt are applied in a work based project. The beauty of this particular programme is that the project is jointly supervised by experts from RIBA and the Management School. The dual perspectives provided are extremely beneficial to the work that is created.”

DR ROGER BEACH,  
ASSOCIATE DEAN OF POST GRADUATE  
PROVISION.

# THE STRUCTURE: WHAT HAPPENS WHEN

---

“Each module is discrete and builds a portfolio of areas each providing an added skill set to those working in the architecture and construction industry. Each stage of the course provides a qualification that can be utilised alongside a portfolio that evidences creative flair, knowledge of construction alongside legal and business acumen.”

DR MARK VAN HOOREBEEK,  
DIRECTOR OF STUDIES.



# PROGRAMME STRUCTURE

**Start date: January and October**

## **Postgraduate Certificate in Architectural and Construction Business Administration**

### **Stage 1**

**Business accounting**

**Business economics**

**Operations management**

**Marketing management**

The accreditation of prior experience will take place at this stage

## **Postgraduate Diploma in Architectural and Construction Business Administration**

### **Stage 2**

**Managing people**

**Corporate finance**

**Business research**

**Strategic management**

The Legal Environment of Business will take place as a 3 day block residential in March/April of each year. Law and Sustainability in the Built Environment will take place as a 3 day block residential in July of each year.

## **Master of Business Administration (MBA)**

### **Stage 3**

**Management project  
(12 - 15,000 words)**

**Project and practice management**

**RIBA strand CPD**

Continuing Professional Development (CPD) activities will be accredited at this stage

# HOW YOU STUDY

---

## How You Study

The Bradford distance learning MBA is flexible allowing you to vary the speed of your progression to suit your needs. Generally, students take two modules per quarter, this equates to 14-16 hours of work per week.

If work or family life is particularly busy you can lighten your workload by taking just one module or even suspend your studies, restarting at a later date. This flexibility allows you to complete a distance learning MBA in two to six years.

As a distance learning student you will make extensive use of our online virtual learning environment. For each module you will be assigned to a small faculty-led tutor group and engage in weekly online discussions and a number of live online tutorial sessions. You will also have the opportunity to monitor your progress through the extensive online multiple choice question banks that accompany each module and one-to-one interaction with your tutor.

## Who You Study With

The Bradford distance learning MBA community is incredibly diverse with students residing in over 40 countries from different industry backgrounds. This diversity allows our distance learning students to enhance their skills and knowledge through communicating with fellow students via the distance learners online social networking site and the small module tutor groups.

## Start date: October and January

- Mode of delivery: Distance-learning and block delivery
- Length of programme: 2 - 6 years
- Average work experience: 10 years
- Average age: 33 years

# A STUDENT PERSPECTIVE

---

“THE STANDARD OF TEACHING HAS BEEN EXCELLENT. MOST OF THE LECTURERS BACK UP ACADEMIC THEORY WITH EXAMPLES FROM THEIR EXTENSIVE INDUSTRY AND CONSULTING EXPERIENCE. ON TOP OF THE CORE AND ELECTIVE SUBJECTS ARE MANY EXTREMELY VALUABLE PERSONAL DEVELOPMENT AND SKILLS WORKSHOPS.”

Andrew Dalziel MBA Alumnus

“I WOULD ADVISE ANYONE WHO IS THINKING ABOUT DOING AN MBA TO GO FOR IT. THERE IS EVERYTHING TO GAIN FROM AN MBA PROGRAMME AND AT BRADFORD I CERTAINLY HAD ALL THE SUPPORT I NEEDED.”

Omoye Okoh Full-time MBA

“I DECIDED THAT STUDYING FOR AN MBA WOULD ALLOW ME TO BROADEN MY SKILL SET, TRY OUT NEW IDEAS WITHIN MY CURRENT ORGANIZATION AND BETTER EQUIP MYSELF FOR MORE SENIOR MANAGEMENT ROLES BOTH WITHIN AN IT CONTEXT AND BEYOND.”

Jon Shaw MBA Alumnus

“THE BEST THINGS TAKE TIME AND EFFORT. WHATEVER STAGE YOU ARE AT IN YOUR CAREER – THE BRADFORD MBA WILL SET YOU UP TO THINK STRATEGICALLY ABOUT BUSINESS ISSUES.”

Simon Browning MBA Alumnus

# OUR ENTRY REQUIREMENTS

---

To be accepted on the Architectural and Construction MBA programme, you will typically have:

- a good first degree from an approved university or
- an acceptable professional qualification, and
- at least three years' significant post-study employment experience. We will make a decision about your entry based on your application form, references, test results and face to face or telephone discussion.

All applicants who are not native speakers of English are required to provide proof of proficiency in English for academic purposes. A score of 6.5 in the IELTS test of English, 580 in the written TOEFL, 240 in the computer-based TOEFL or 94 or better in the internet-based TOEFL is the minimum requirement.

If you have narrowly failed to meet these standards in English, you can take a six-week summer course to make up the difference. We encourage you to contact us in advance of an application to discuss your eligibility for entry.





We recognise that there are experienced and able managers who may not immediately fulfil our normal entry requirements, in which case you are encouraged to apply and be considered on the merits of your career profile and achievements. Once you have applied, we will use a number of methods to evaluate your suitability for admission.

Firstly, the documents you provide will allow us to form a preliminary judgement about your suitability. Suitable applicants will be asked to complete either The Bradford Test or GMAT.

A GMAT score of 600 or above will fulfil our requirements. If this has not been met The Bradford Test is offered.

The Bradford Test is a two-part diagnostic ability test of approximately 40 minutes each, assessing verbal and numerical reasoning. Your results are compared to an average attained by individuals from a similar professional management background and feedback is provided to all candidates.

# HOW TO APPLY

---

We consider each application as soon as we receive it, so we advise you to apply as soon as possible. Student selection is based on a combination of qualifications, experience, motivation and potential.

To apply for the Bradford MBA:

- complete the application online at [www.bradford.ac.uk/management/apply](http://www.bradford.ac.uk/management/apply)  
Ask two referees (from your employer or academic institution) to complete a copy of the confidential reference form which can be found at [www.bradford.ac.uk/management/mbaref](http://www.bradford.ac.uk/management/mbaref) and return it directly to the Admissions Office.

## To find out more

We hold regular MBA preview events throughout the year where you can meet some of our staff, students, and tour the campus facilities, which you are welcome to attend.

Visit [www.bradford.ac.uk/mbapreviews](http://www.bradford.ac.uk/mbapreviews) for dates and further information. Alternatively, if you can't make any of our dates and would like to come and visit us, please get in touch and we would be delighted to make an appointment to meet at a time that suits you. Contact us at [mba@bradford.ac.uk](mailto:mba@bradford.ac.uk).

We also attend a number of fairs in the UK and internationally.

Details of the fairs we are attending can be found at:

[www.bradford.ac.uk/management/fairs](http://www.bradford.ac.uk/management/fairs)

In addition we have overseas representatives in most countries who can help you with any queries you may have:

[www.bradford.ac.uk/international/overseas-representatives](http://www.bradford.ac.uk/international/overseas-representatives)



## **Application**

For further information on how to apply for the Bradford MBA, visit [www.bradford.ac.uk/mba](http://www.bradford.ac.uk/mba)

## **Application Fees**

We do not charge any application fees.

However, we require a deposit if you accept a place offered by us.

This guarantees your place on the programme and is deducted from your tuition fee.

You must confirm your wish to take up the place by paying the deposit within four weeks of the date you receive our offer letter.

If you do not pay the deposit within this timescale, you will not be allocated to a learning set and, although we will continue to hold your application on file, you will receive a place only if we have not filled our recruitment quota. The deposit is a pre-payment, not an extra charge, and will be deducted from your tuition fee.

The information set out in this document is subject to change. Please access the website for further information.

RIBA North West  
milkandsugar  
The Tea Factory  
82 Wood Street  
Liverpool  
L1 4DQ  
Tel: +44 (0)151 703 0107  
Email: [riba.northwest@inst.riba.org](mailto:riba.northwest@inst.riba.org)  
Webpage: [www.architecture.com/mba](http://www.architecture.com/mba)

Bradford University School of Management  
Emm Lane  
Bradford  
BD9 4JL  
Admissions Office  
Tel: +44 (0)1274 234 321  
E-mail: [mba@bradford.ac.uk](mailto:mba@bradford.ac.uk)  
E-mail: [m.vanhoorebeek@bradford.ac.uk](mailto:m.vanhoorebeek@bradford.ac.uk)  
Webpage: [www.brad.ac.uk/management/ribamba](http://www.brad.ac.uk/management/ribamba)

